

2 | m002_montage 02
1: 200

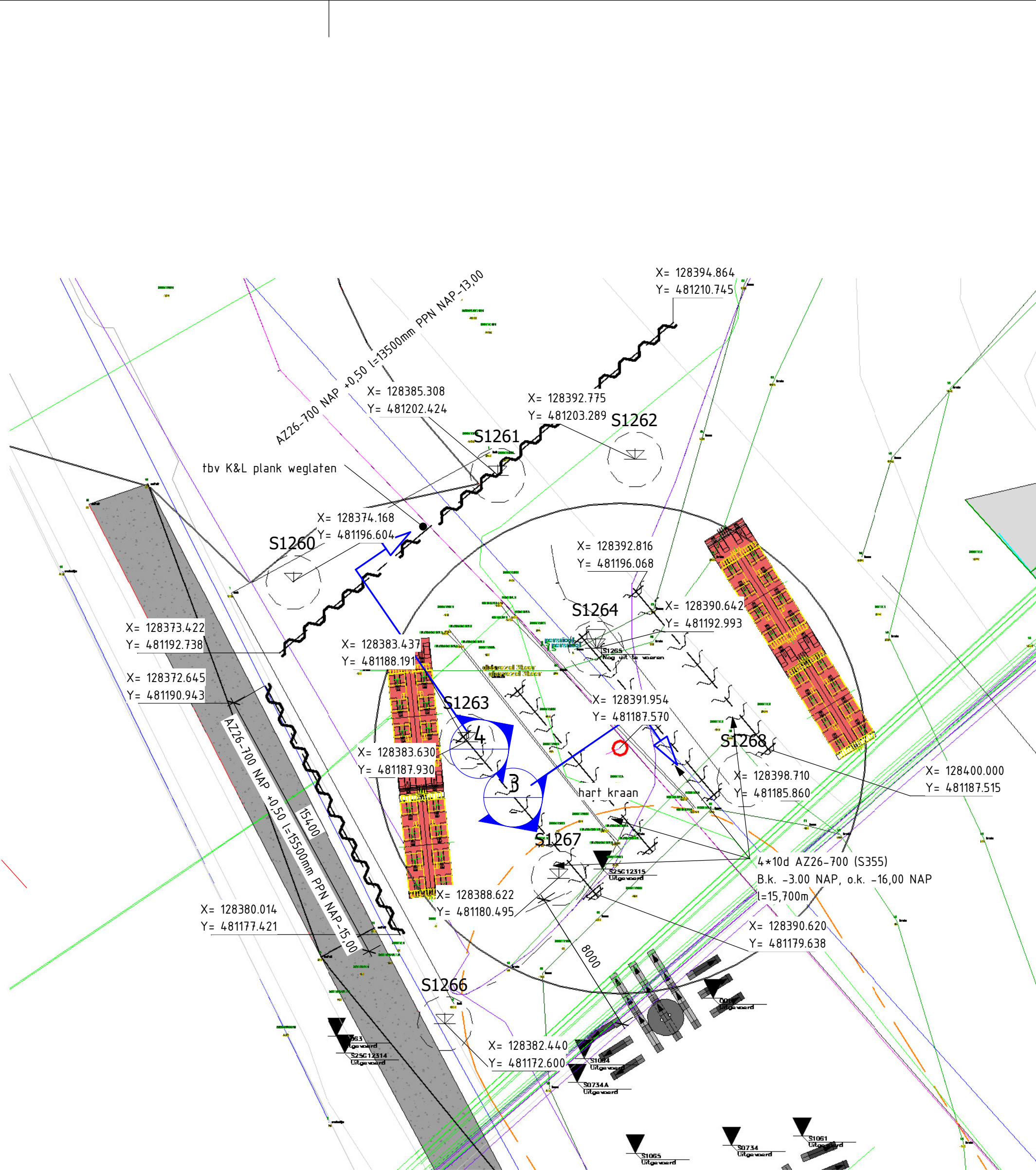

3 | raakvlak K&L damwand
1: 200

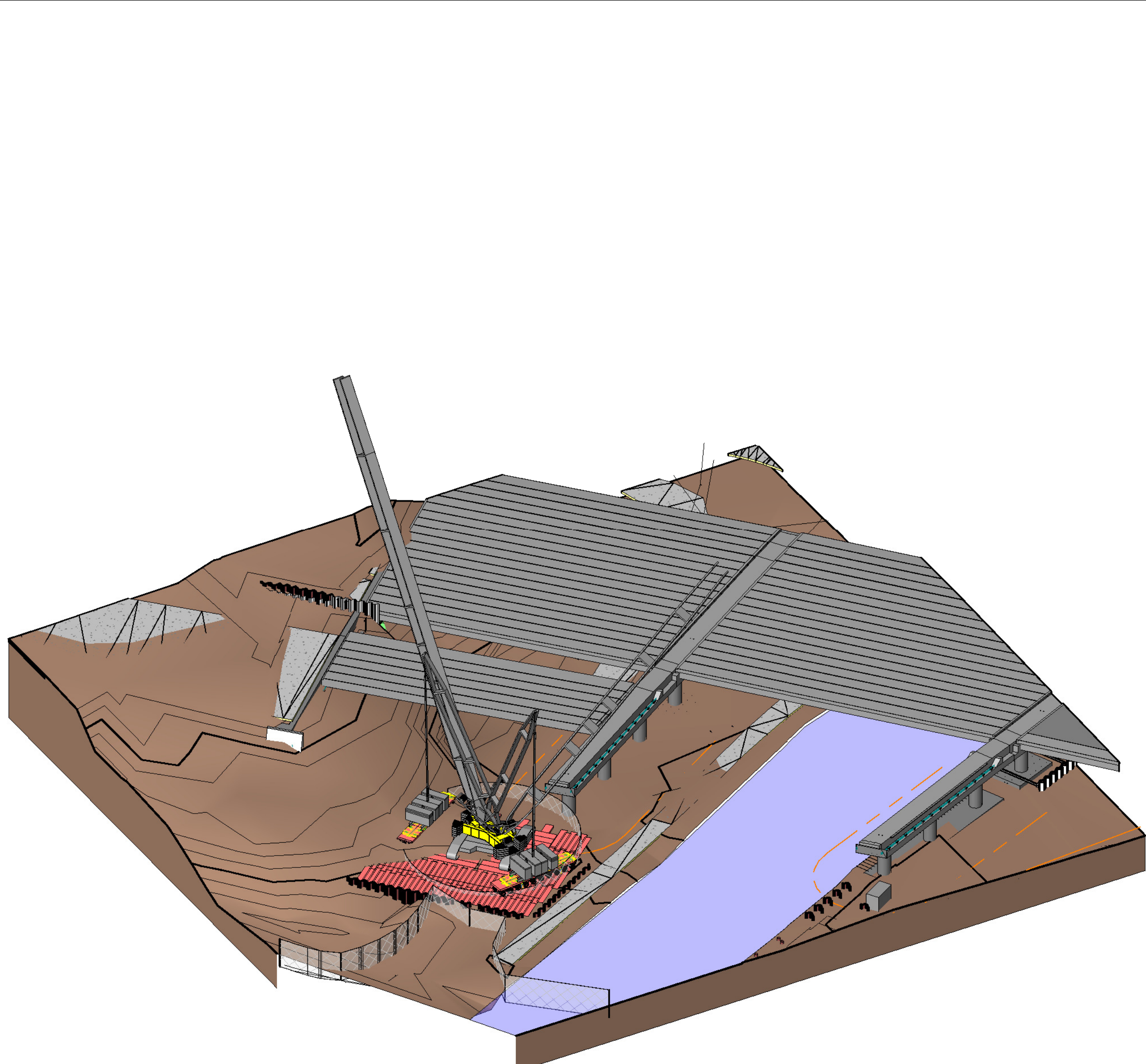

1 | montage 02 Moot 5 deel 2

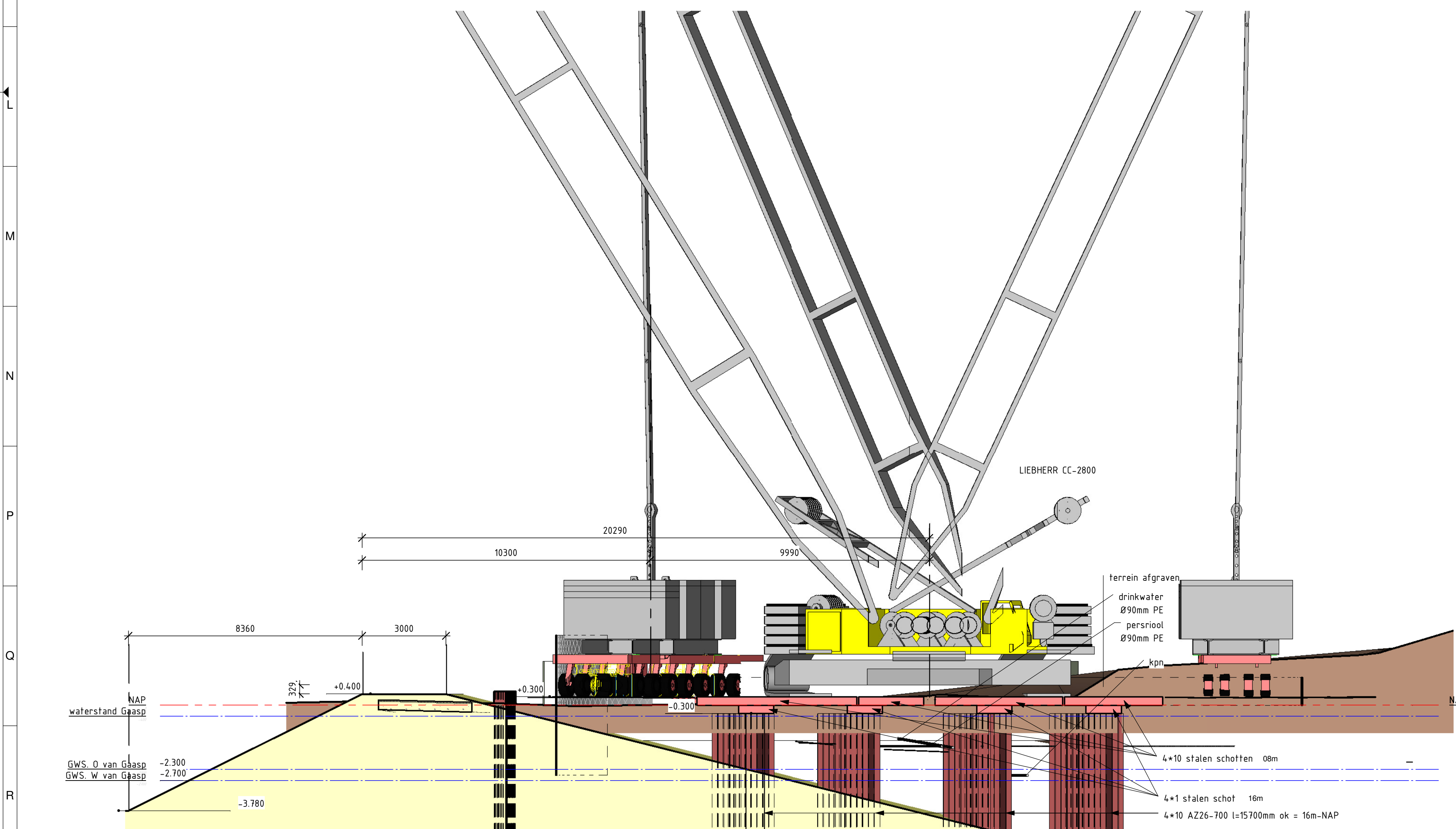

4 | drin-as05-01
1: 100

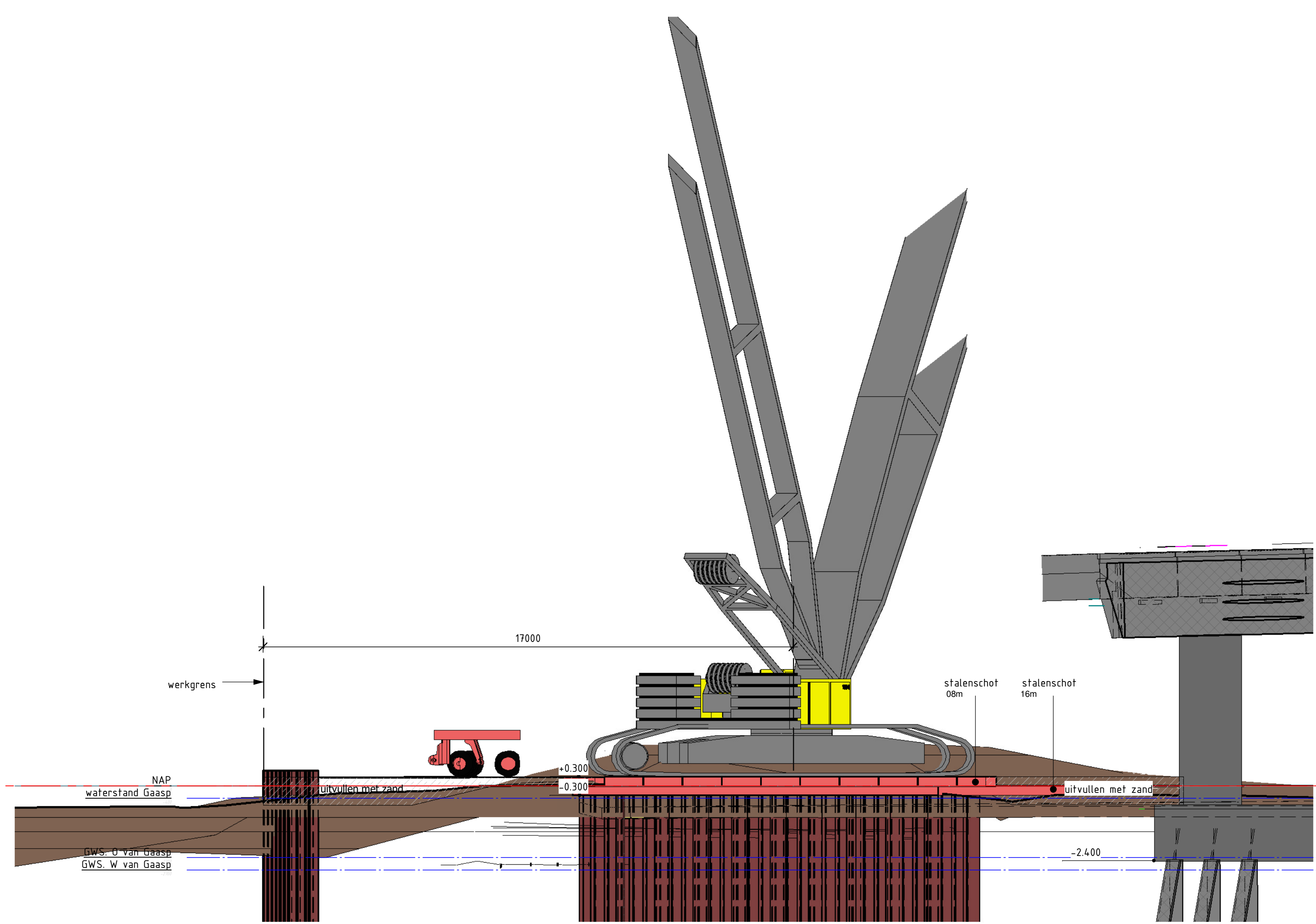

5 | drin-as05-02
1: 100

Legenda:

| Toe te passen stalen schotten, van Woud. | | | | |
|--|---------|-------|---------|----------------------|
| lengte | breedte | dikte | gewicht | max. t.l.b. puntlast |
| 08m | 1,24m | 0,30m | 4450kg | 52 |
| 10m | 1,24m | 0,30m | 5800kg | 42 |
| 12m | 1,24m | 0,35m | 6500kg | 32 |
| 16m | 1,24m | 0,30m | 9300kg | 24 |
| 18m | 1,24m | 0,30m | 10500kg | 23 |

Toe te passen azobe schotten, van Woud.

| lengte | breedte | dikte | gewicht | +stalen kop |
|--------|---------|-------|---------|-------------|
| 06m | 1,00m | 0,20m | 1440kg | 1524kg |
| 07m | 1,00m | 0,20m | 1680kg | 1764kg |
| 08m | 1,00m | 0,20m | 1920kg | 2004kg |
| 10m | 1,00m | 0,30m | 3600kg | 3803kg |
| 12m | 1,25m | 0,30m | -- | 7438kg |

ophoogzand aanbrengen in lagen van 0,3m aantillen.
verdichten tot 5 mPA.

Referenties:

inmetingen A9-KW22_08 SIT-N02.dwg
SNL160699_N00RD_VELD-1_LIFT_01_CC.dwg
SNL160699_N00RD_VELD-2X3_LIFT_01_CC.dwg
SNL160699_N00RD_VELD-4_LIFT_01_CC.dwg
SNL160699_N00RD_VELD-5_LIFT_01_CC.dwg
Xref-DTH_GBNK_v000.dwg
Xref-G02_sonderingen_v020.dwg
Xref-KLM_Gaasperdammerweg_A9_v012.dwg
IXAS_KW022-Bovenbouw_v005.rvt
IXAS_FNSC-damwandTOTAAI-AB_v002b.rvt
IXAS_Kabels-Leidingen_c00a.rvt
Xref-DTH_ondergrond_3Dv005_JWB0-A9-01.rvt
Xref-DTH_ondergrond_3D_v005_JWB0-verharding.rvt

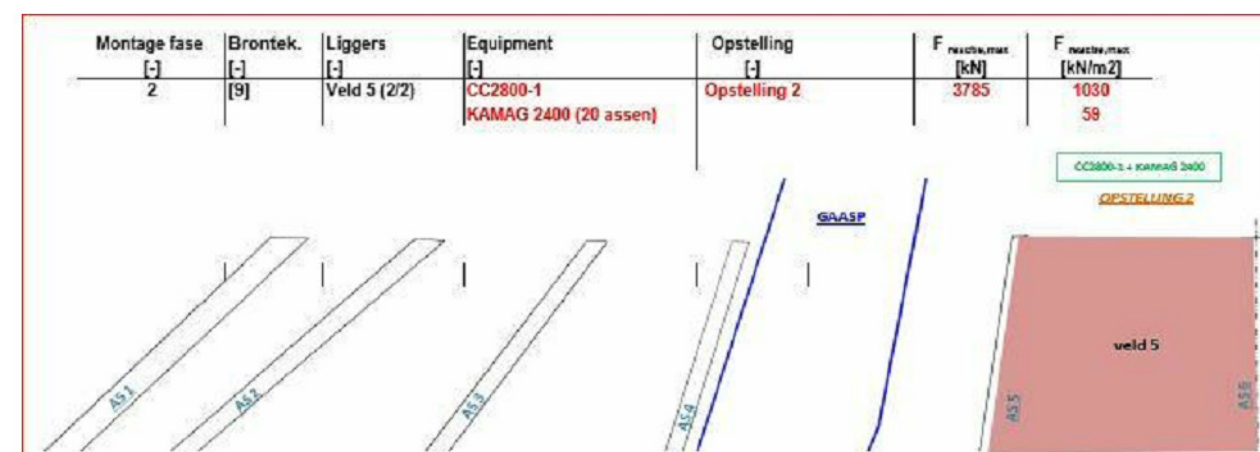

IXAS

Rijswaterstaat
Ministerie van Infrastructuur en Milieu

Opst: JWS
Geen: PRE
Aur: PRE
Team: TM 630
Documenttype: Tekening Algemeen
Onderwerp: VOR - Vormtekening
Titel: Kraanopstelling montagefase 2
Projectfase: Fase overstijgend
Obj: 000232
Actie/type: ATY DWA04
Segment: S000
Fastring: Gehele Object
Verke:

IXAS
VRIJGEGEVEN
VOOR CONSTRUCTION
P. RENDERS



formaat: A0
schaal:
Printdatum: 14-3-2017 16:40:45

Doc nr: A9GDW-TEK-14-202
UO-T-ALG-HLP-035
Revisie: 1.0