

Principeprofiel 1

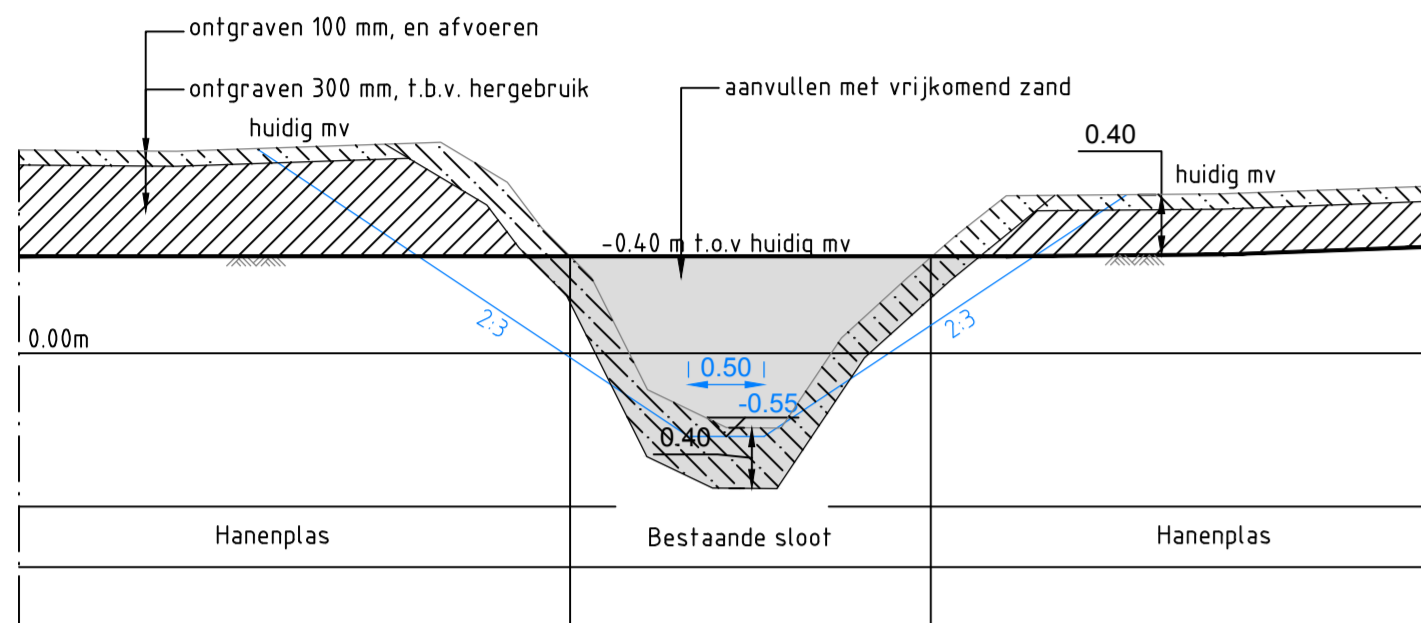

Profiel 2

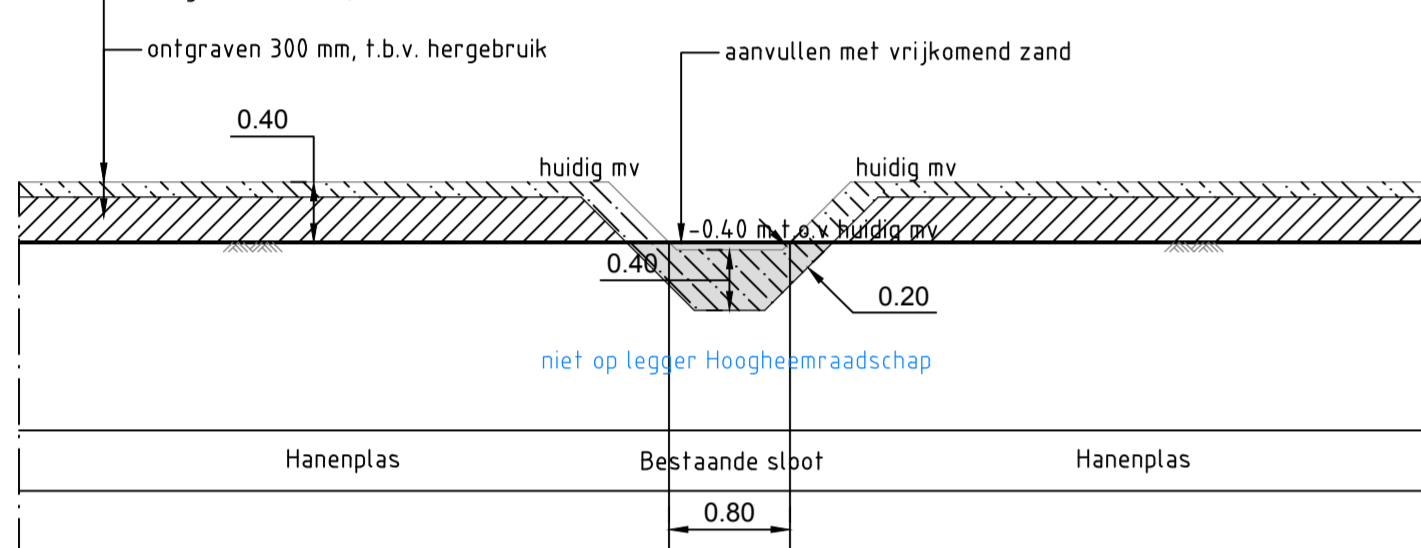

Principeprofiel 3

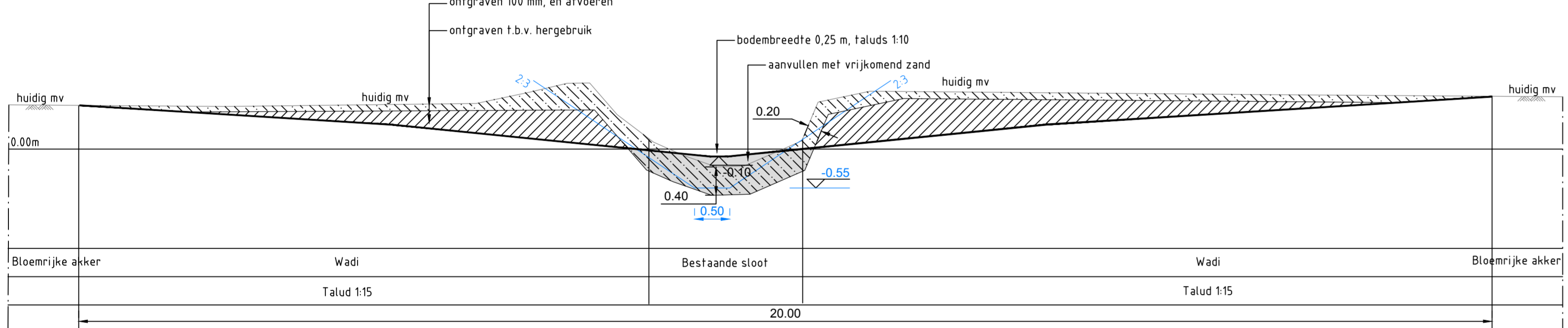

Profiel 5

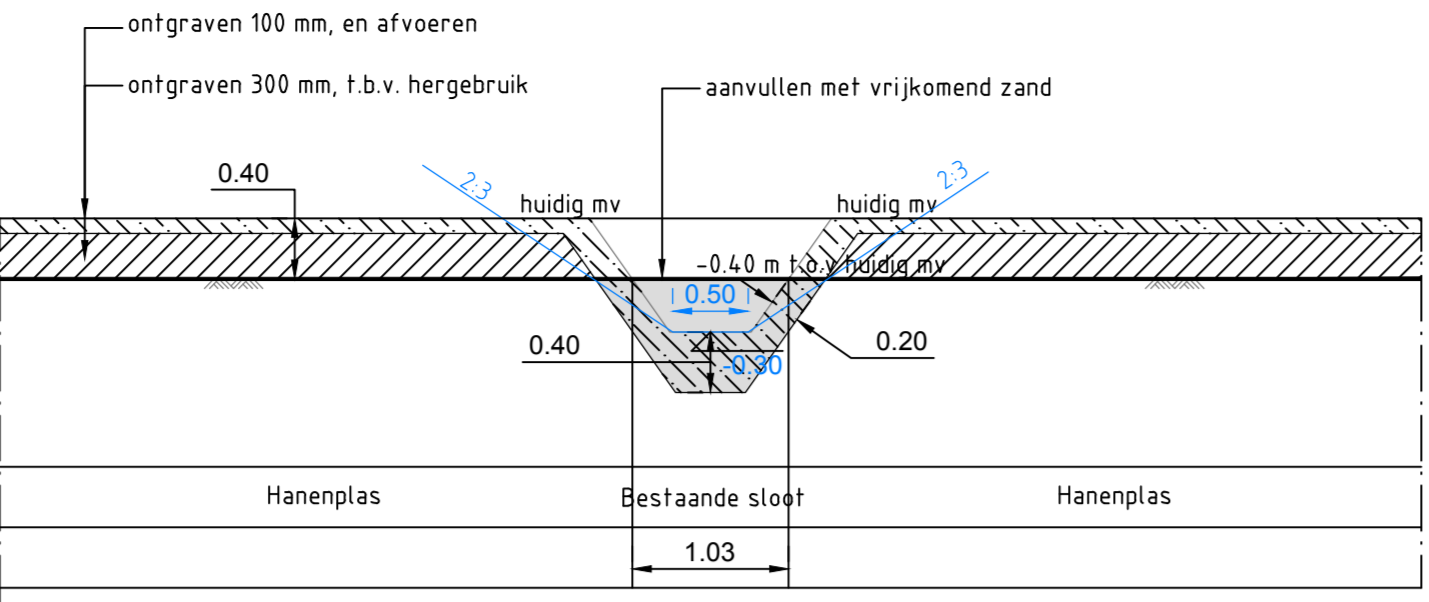
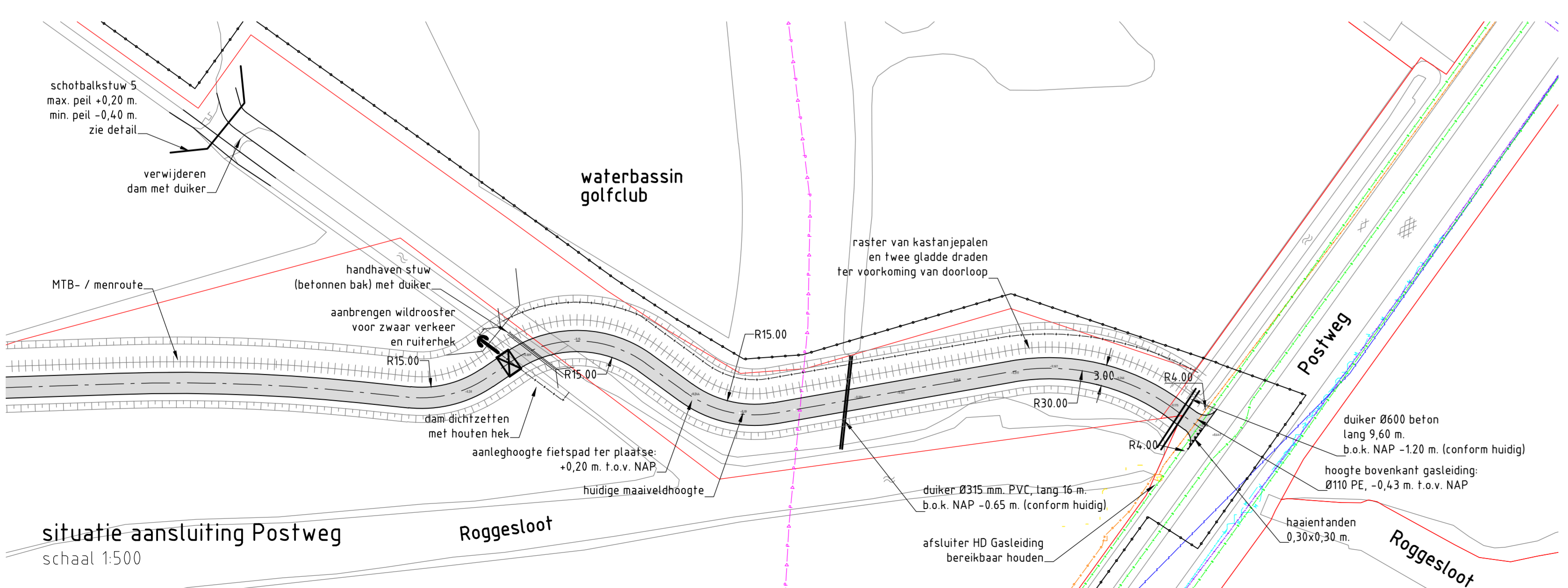

Principeprofiel 4

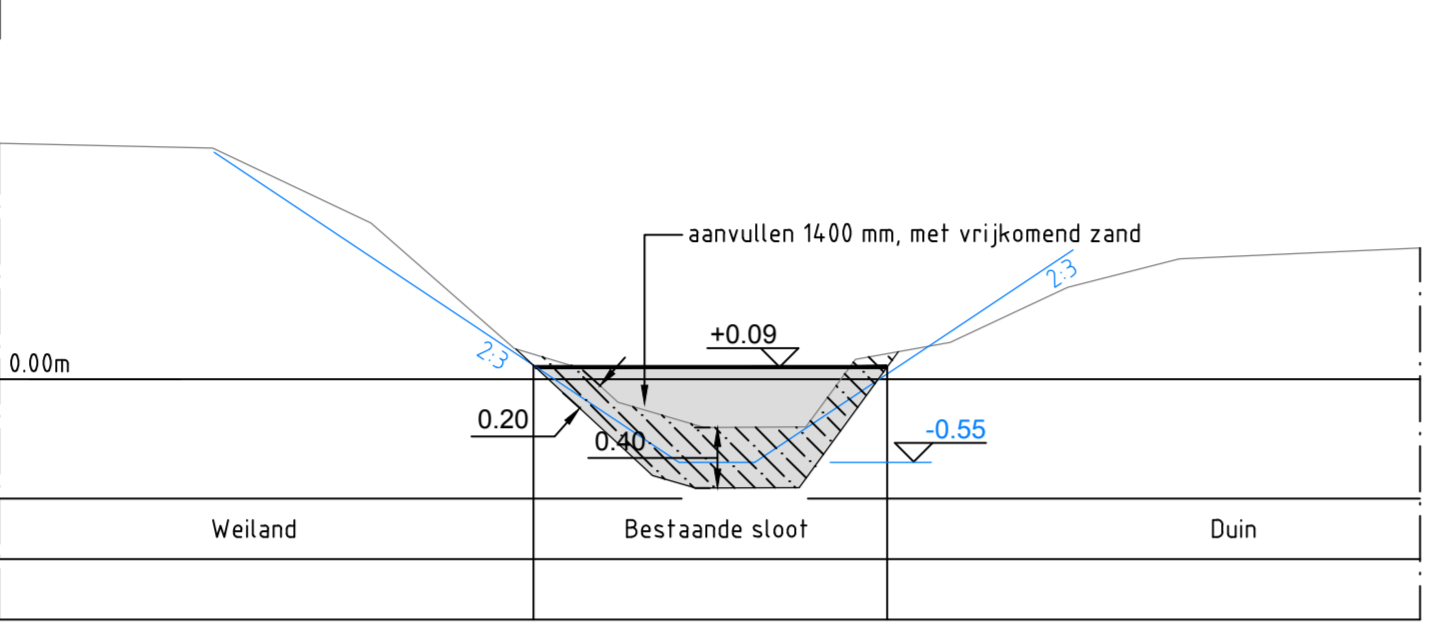

Profiel 6

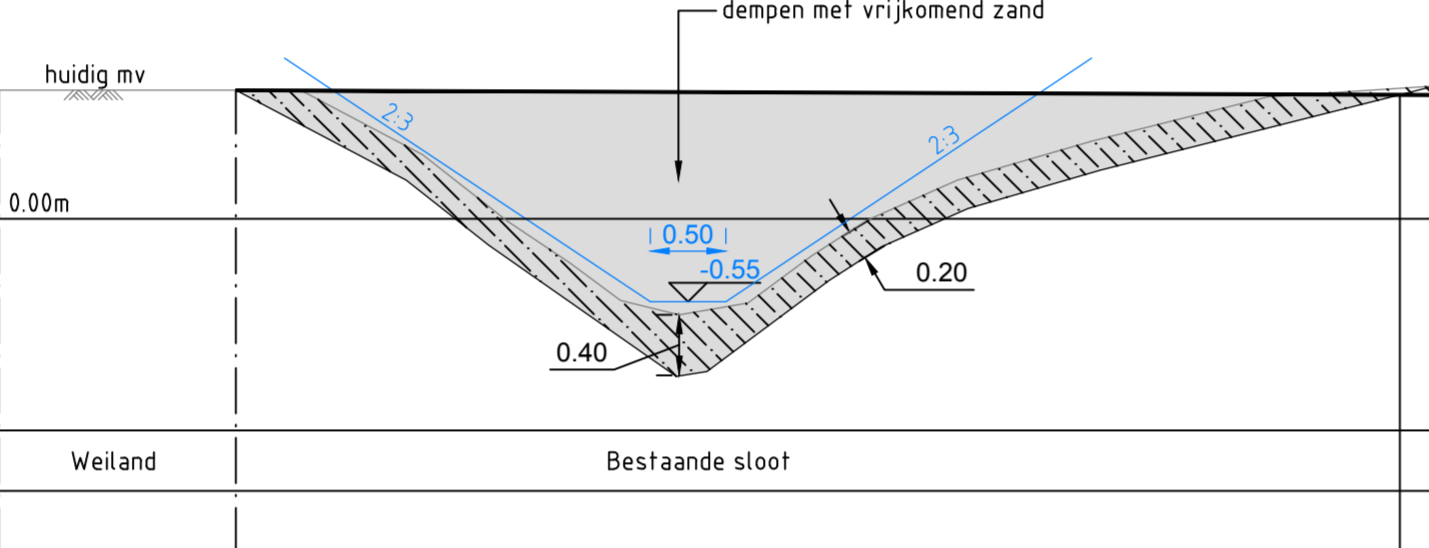

Profiel 7

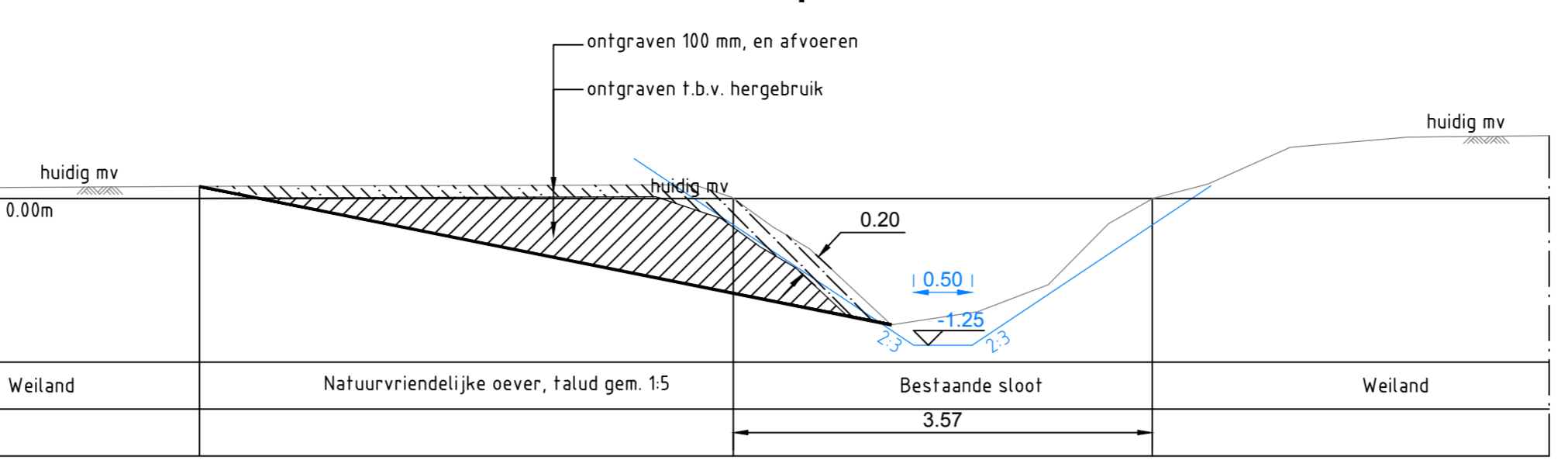

Profiel 8

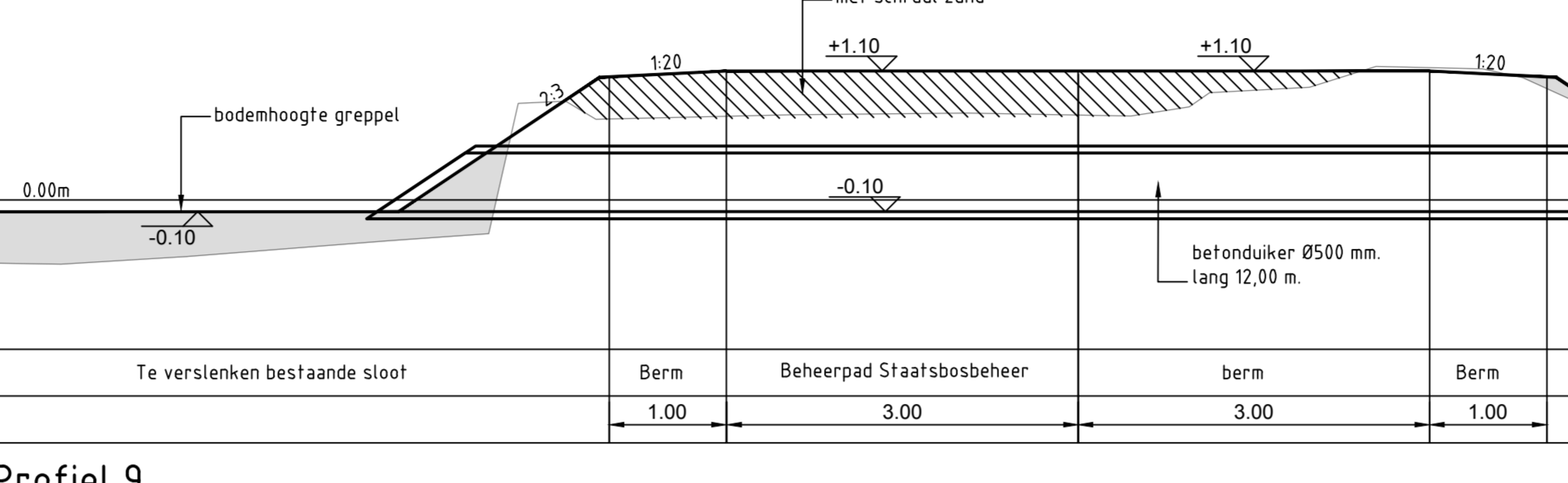

Profiel 9

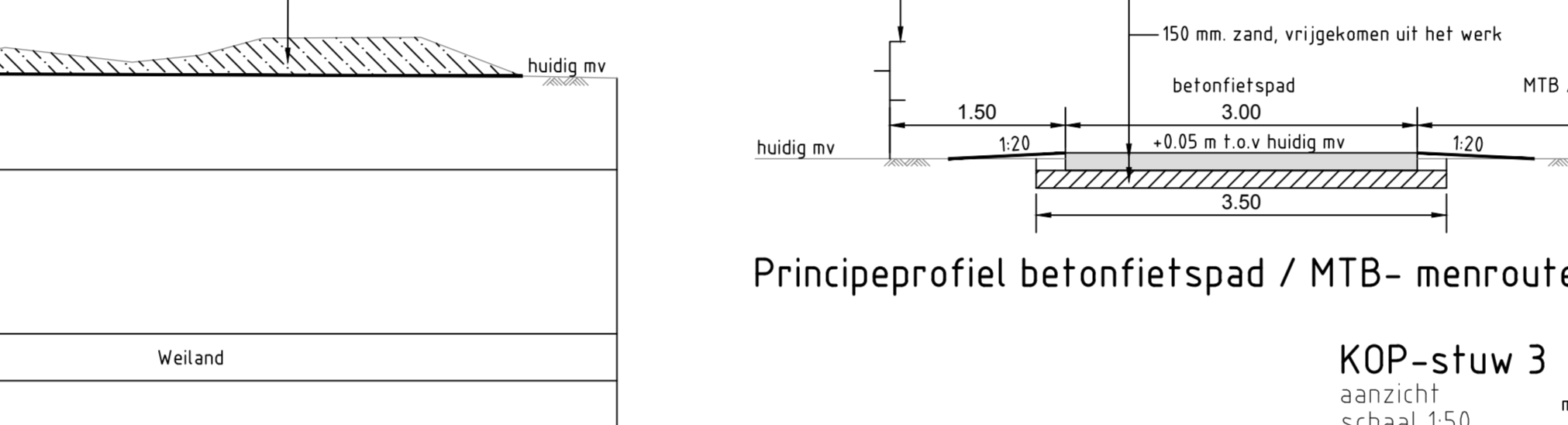

reg. nr. 17.89654



Voorbeeld veerooster

### VERKLARING

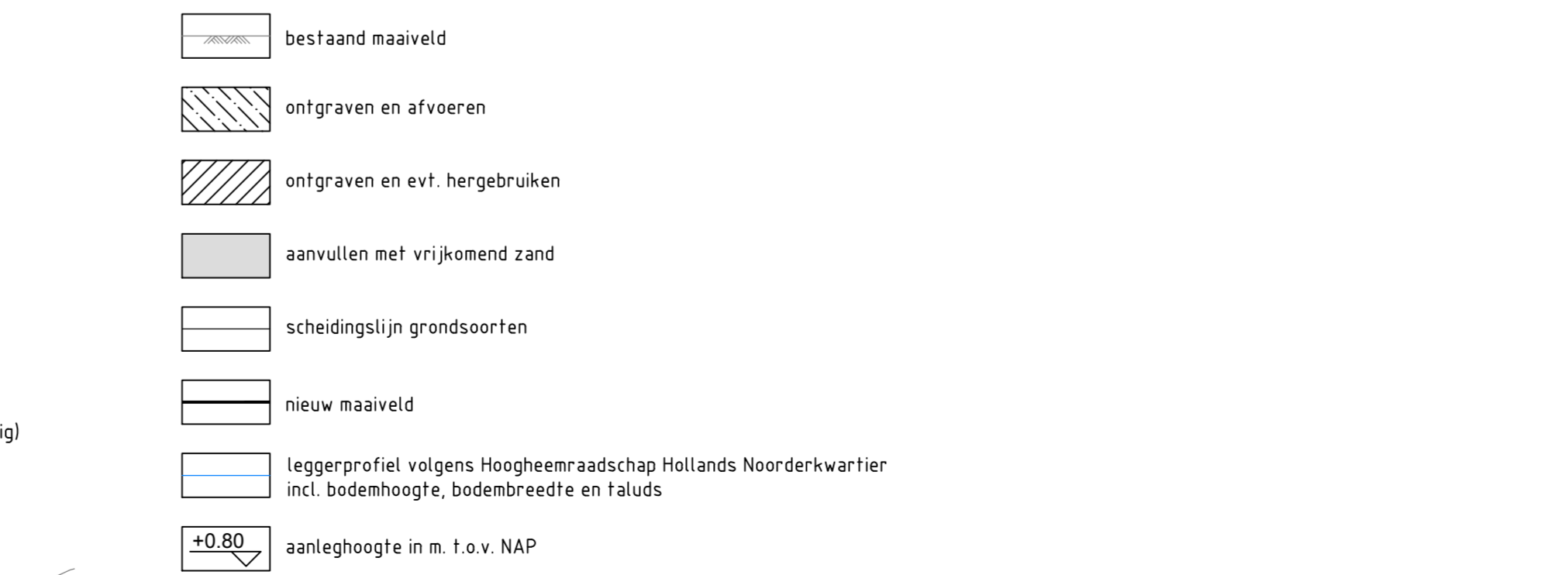

### OPMERKINGEN

- profiel 1, 2 en 4 (in de Hanenplas) op basis van veldinschatting  
- peilschalen toepassen bij stuwen

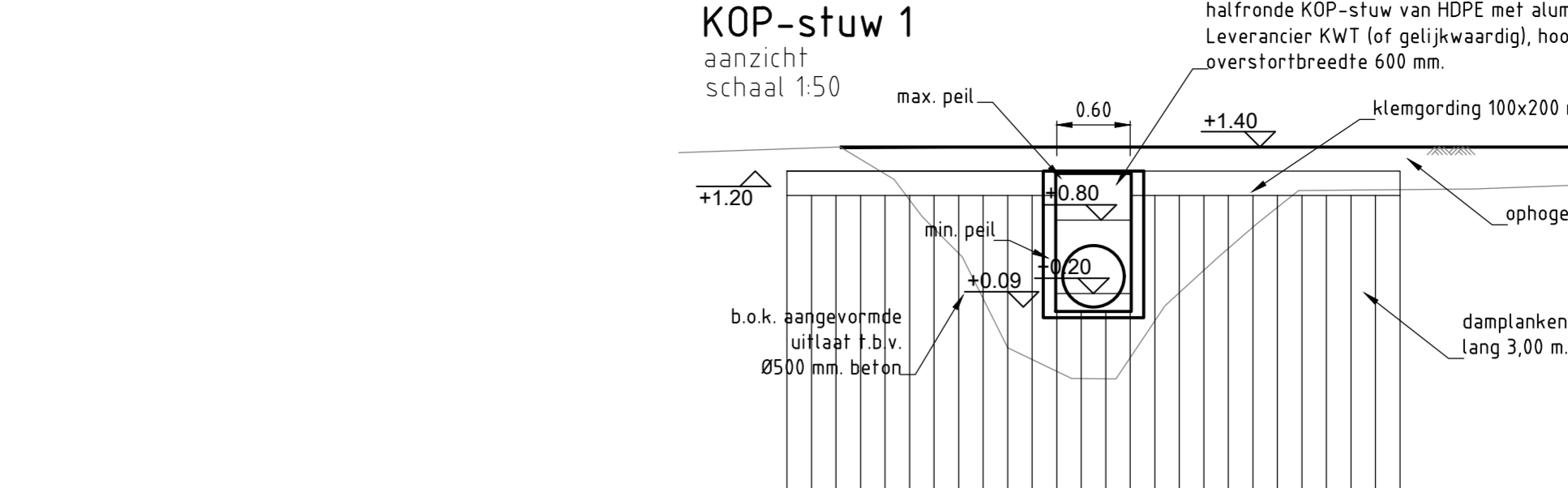

KOP-stuw 1 aanzicht

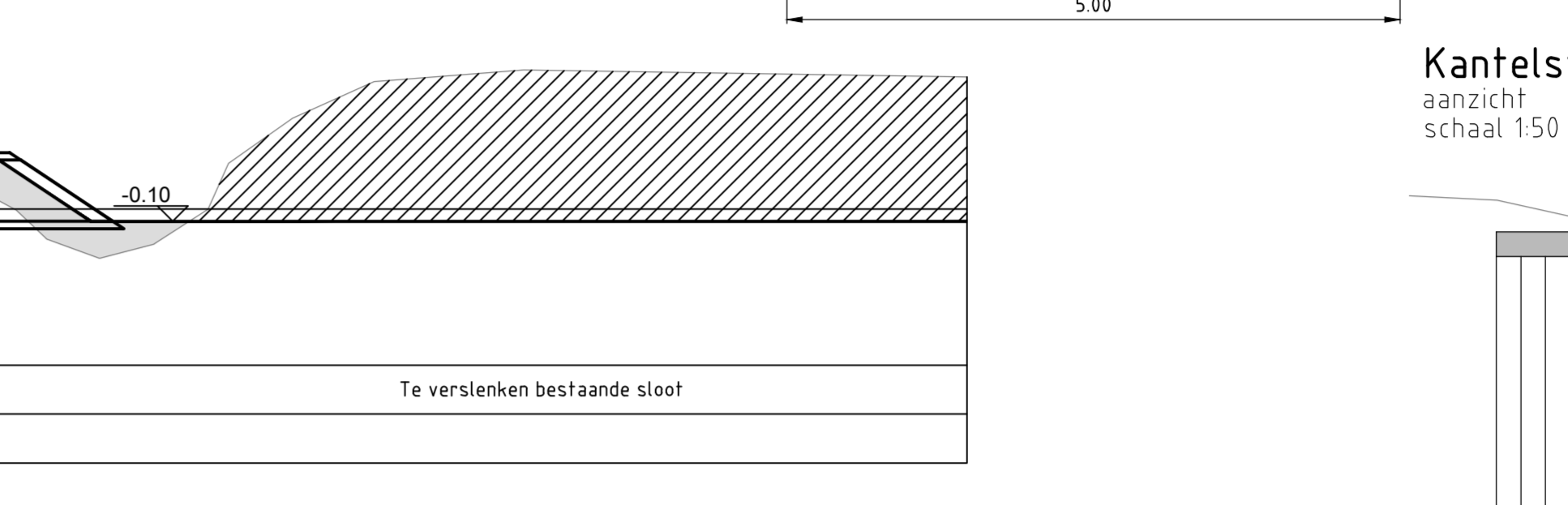

Kantelstuw 2 doorsnede



KOP-stuw 3 aanzicht

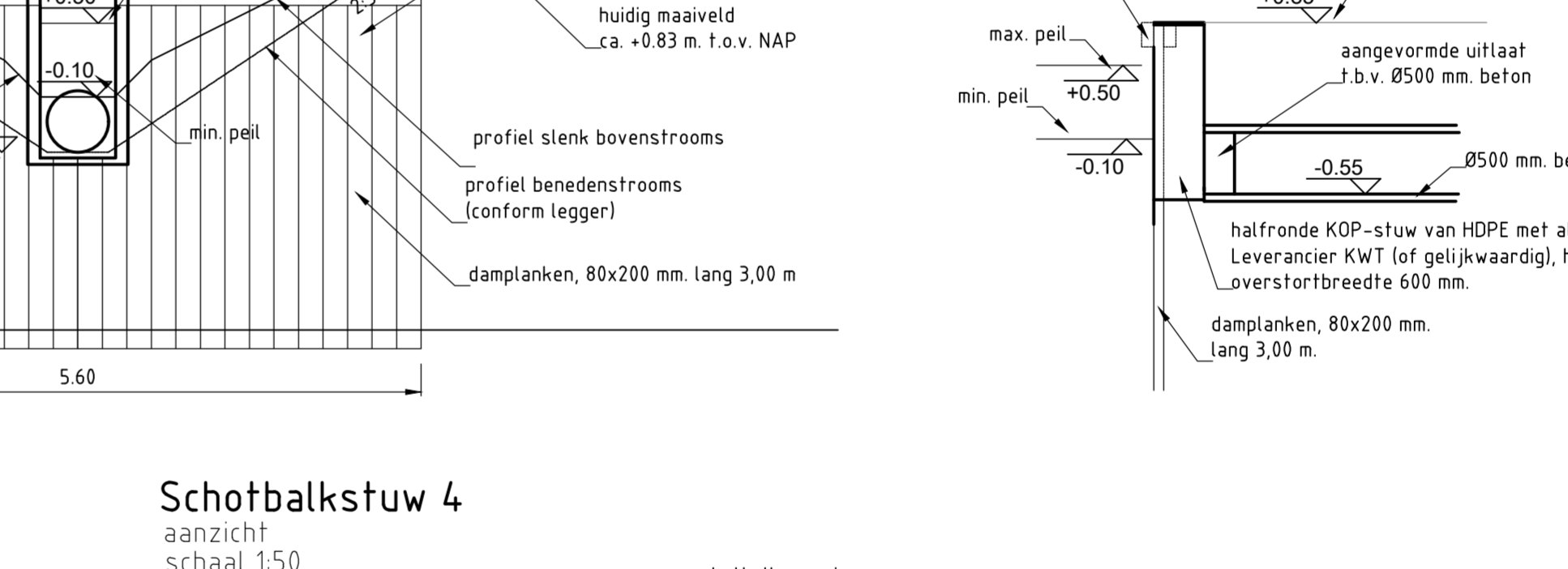

Schotbalkstuw 4 aanzicht

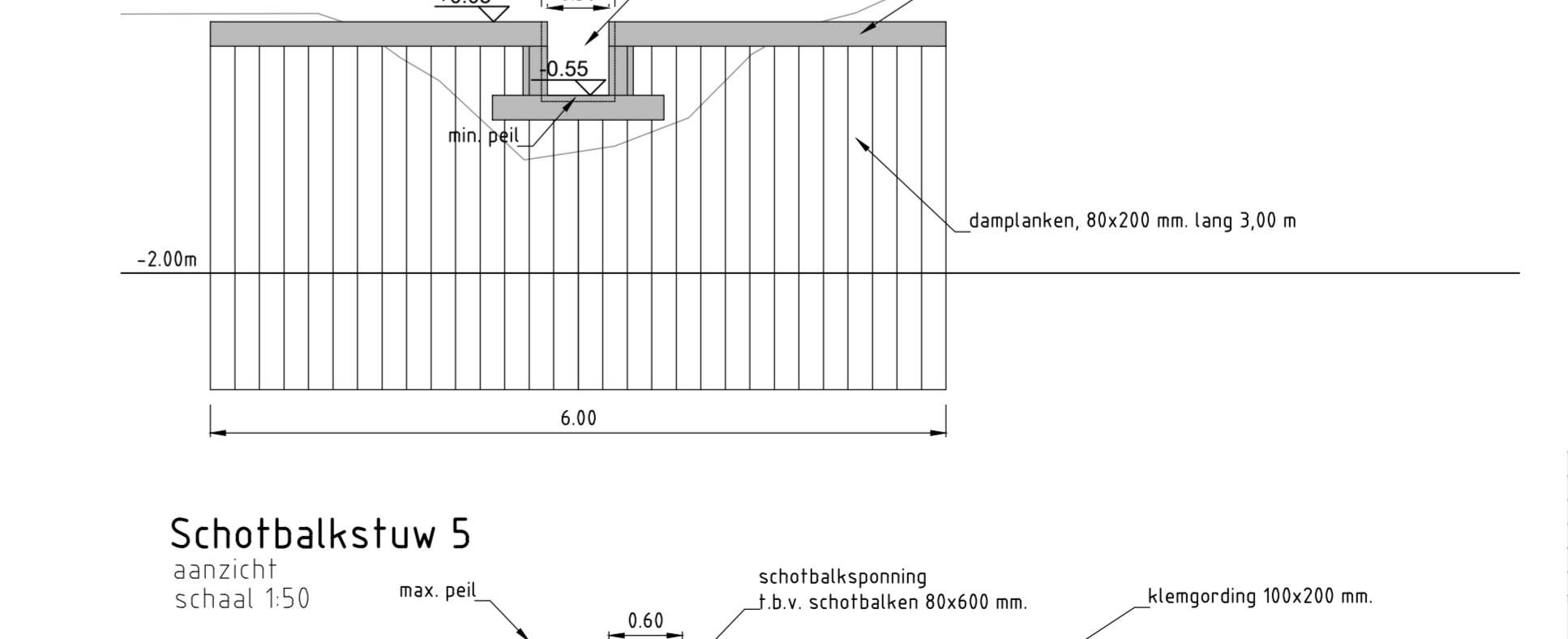

Schotbalkstuw 5 aanzicht

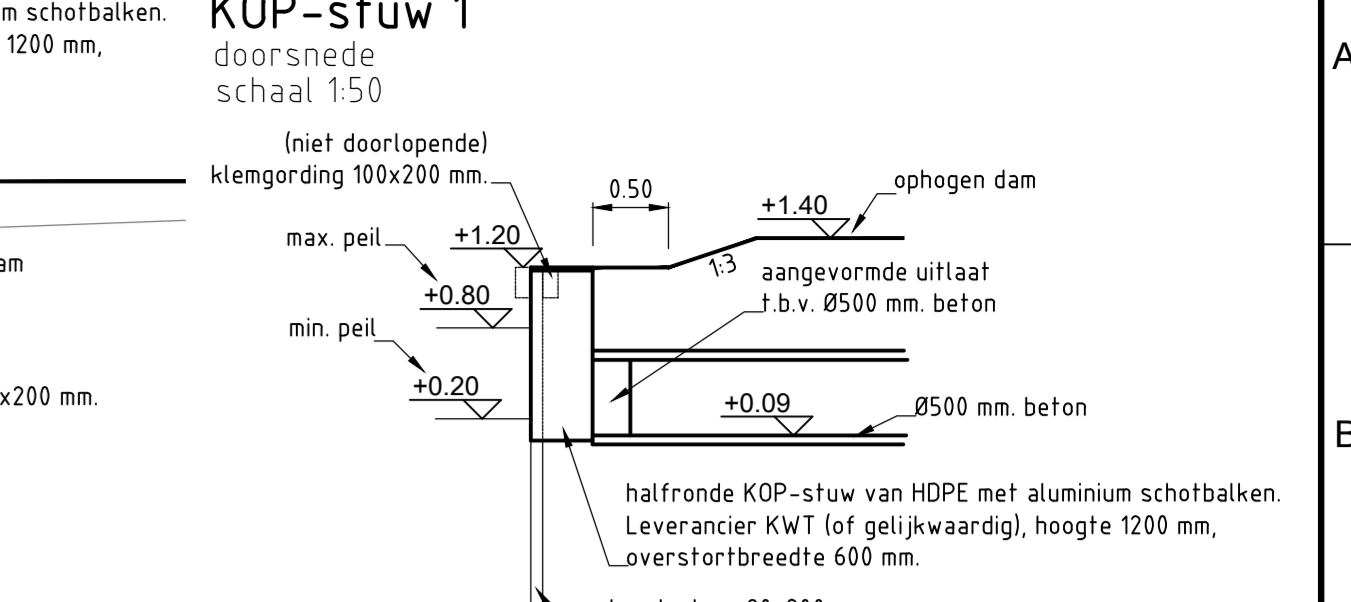

KOP-stuw 1 doorsnede

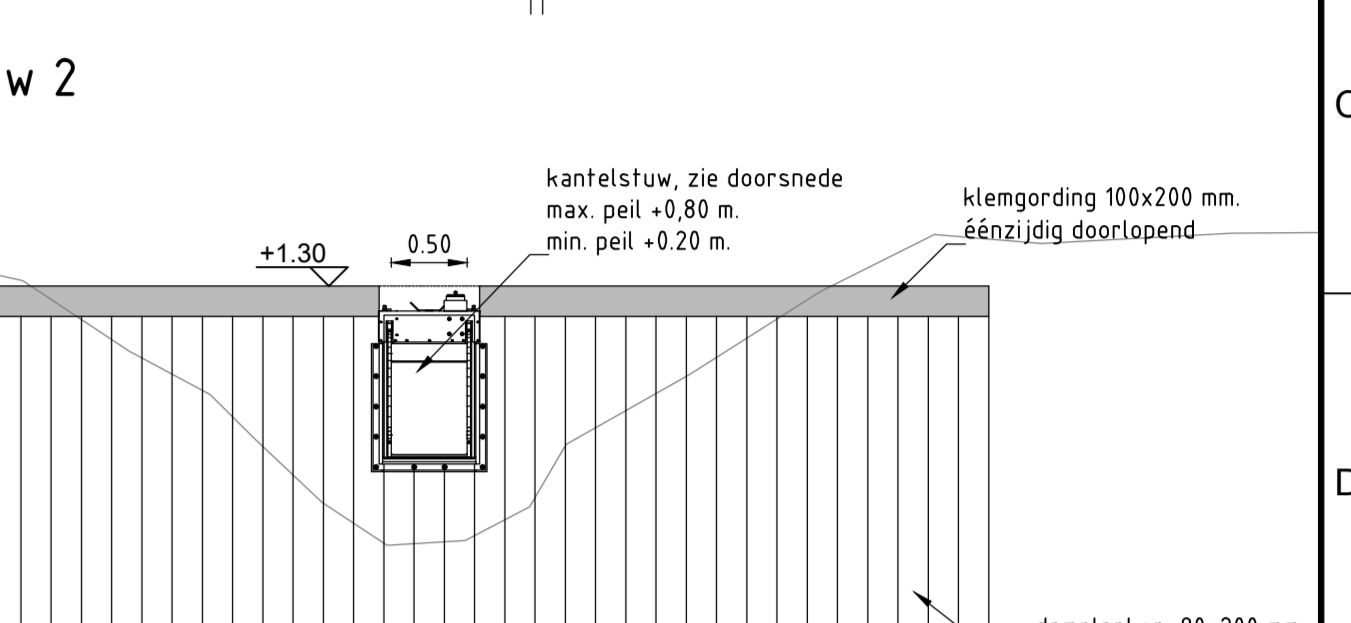

Kantelstuw 2 doorsnede

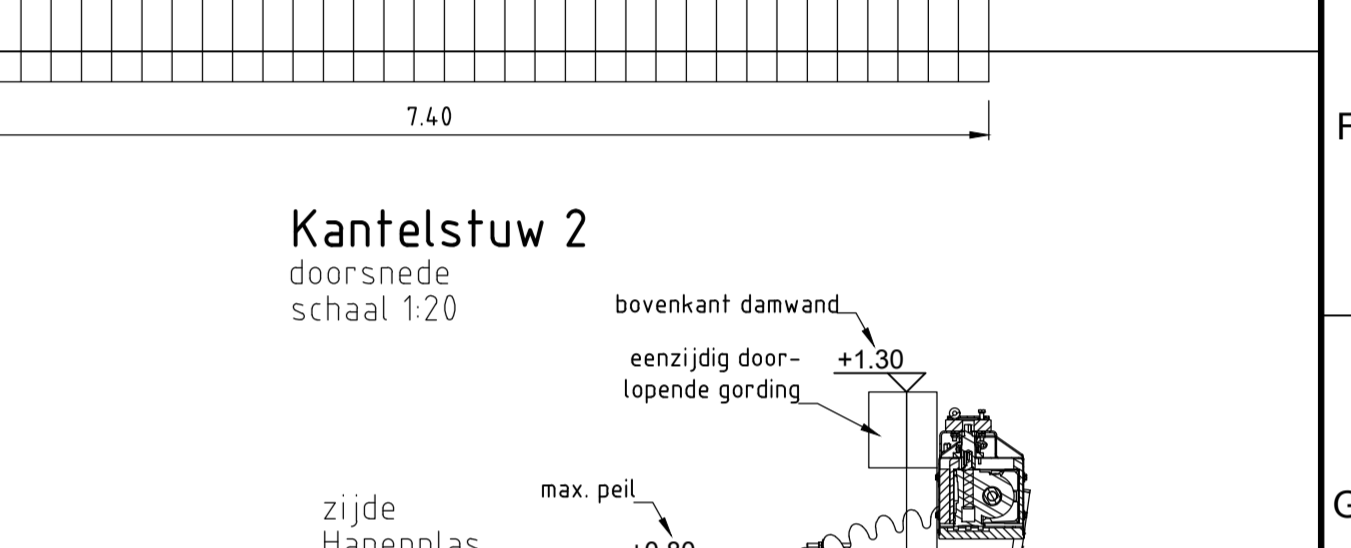

Kantelstuw 2 doorsnede

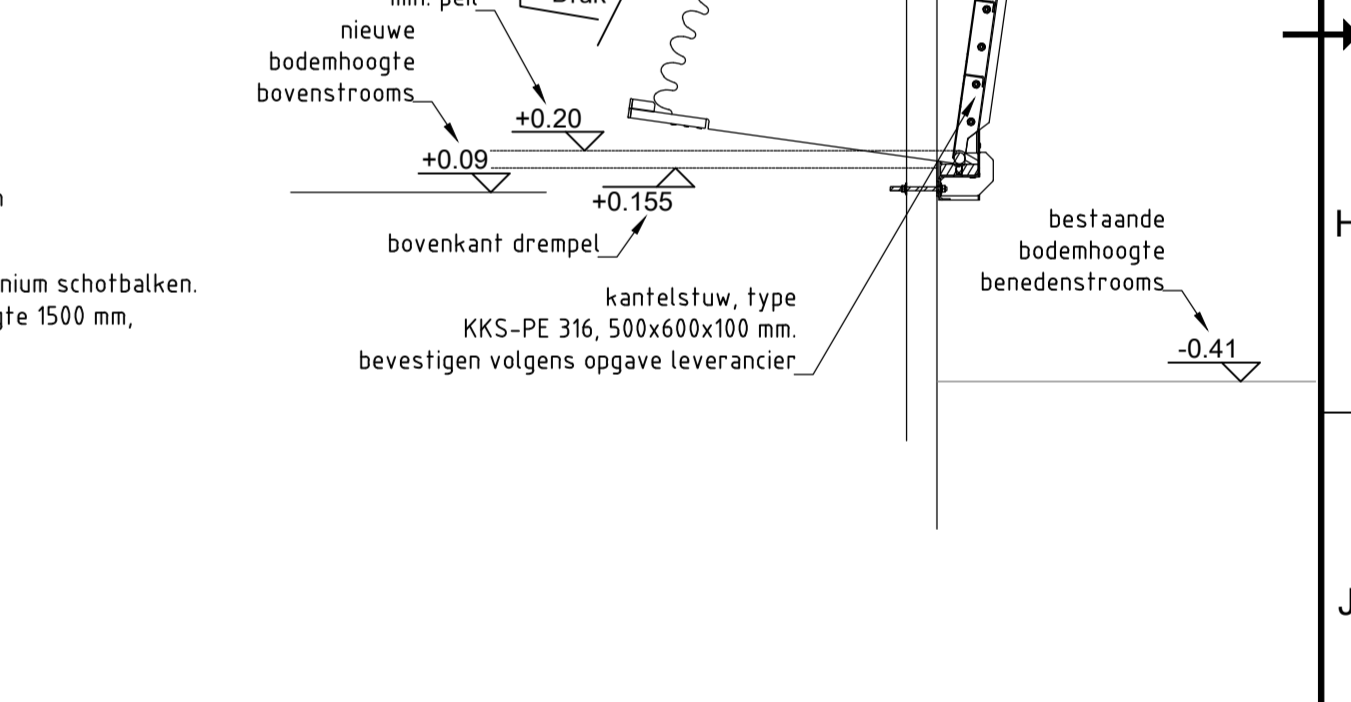

principe schotbalkspanning stuw 4 en 5

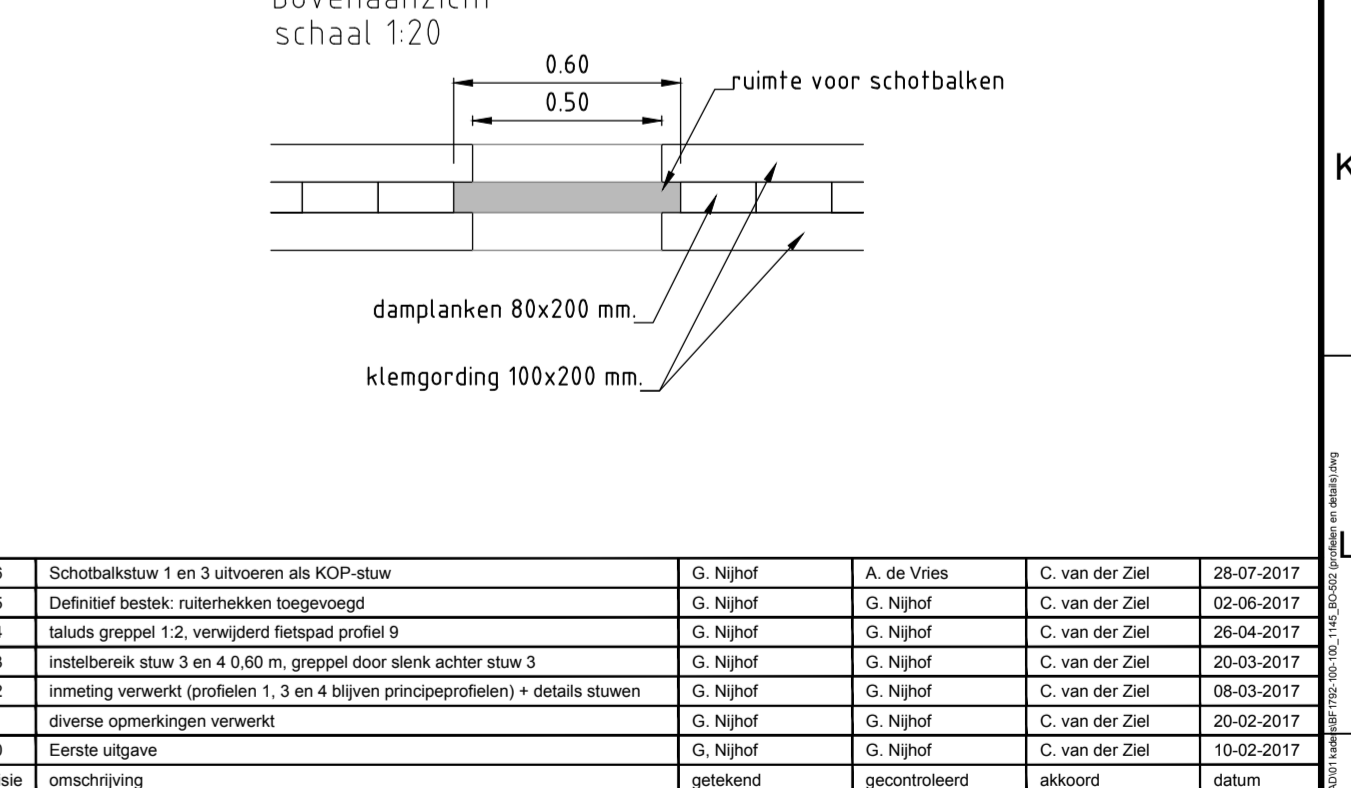

provincie Noord-Holland

project	Natuurontwikkeling Hanenplas, Texel	documentversie	6
omschrijving	profielen en details	documentnummer	BF1792-100-100_1145_BO-502
formaat	A1.0	schaal	1:50 / 1:20 / 1:500
base	voor uitvoering	bladnr.	03
van		van	